



TODD BLAKE VERWERS

Nationality USA

Education The Royal Danish Academy of Fine Arts, Copenhagen, Denmark
 Kansas State University, USA (Bachelor of Architecture)

Professional Affiliations Federation of Danish Architectural Firms (Danske Ark)
 American Institute of Architects (1994–1999)
 AmCham (American Chamber of Commerce in Copenhagen)
 Danish-American Chamber of Commerce of Northern California (1992-2006)
 Swedish-American Chamber of Commerce of Northern California (2002-2006)

Key Qualifications

- project architect with experience over a broad range of project types
- award-winning architectural designer
- refined, minimalist design aesthetic
- extensive technical and detailing expertise
- significant international experience on large, prestigious projects
- accomplished architectural writer, educator and juror

Languages English
 Danish

Architectural Licensure State of California (USA)
 Denmark (EU)

Academics Censor - The Royal Danish Academy of Fine Arts (2018-)
 Adjunct Professor - California College of the Arts (1998-2001)
 Visiting Lecturer / Guest Critic - University of California at Berkeley (1995 - 2005)

Articles / Papers **The Renaissance of American Prefab (Præfabs Genfødsel i USA)**
Arkitekten No.14/2007, pages 34-47

John Pawson: The Simple Expression of Complex Thought





TODD BLAKE VERWERS

Arkitekten No.1/2012, pages 45-49

New Nordic: Regional Identity and the Third Wave of Nordic Architecture
Arkitekten No.8/2012, pages 66-71

Awards

Folsom Street Residential Laboratory

Honor Award - International Interior Design Association (IIDA) 2005
 Award of Merit – Residential Architect Magazine 2005

Elevation Salon + Café

San Francisco Magazine “Best of the Bay” Award 2000

Nordic Art & Cultural Center Competition

Honorable Citation 1993

Dwelling Block in Bratislava City Centre

Second Prize – Bratislava, Czechoslovakia 1988

Mero Modular Carpet Design

Second Prize 1983

Distinctions

Board Member at Lyngby Private School in Copenhagen (2014-2018)

Vice President of The American Club in Copenhagen (2008-2019)

Juror at Portland AIA/IIDA Annual Interior Design Awards (2002)

Board Member of Bernal Heights East Slope Design Review Board San Francisco (2002)

President of Danish-American Chamber of Commerce of Northern California (1999)

Kansas State University Cum Laude Graduate GPA 3.40/4.00

High School Valedictorian GPA 3.97/4.00

Recipient of Weigel Architectural Scholarship (Kansas State University)

Member of Tau Sigma Delta Honor Society in Architecture & Applied Arts

Lectures

Scandinavian Design – Attitude & Form

Swedish-American Chamber of Commerce - San Francisco 2003

Rigor & Refinement in Danish Architecture: The Work of Arne Jacobsen





TODD BLAKE VERWERS

University of California - Berkeley 1999

Danish Modern to Silicon Image: A Comparison of Design Traditions
Danish Information Systems Professionals - Palo Alto 1999

Rigor & Refinement in Danish Architecture: The Work of Arne Jacobsen
American Institute of Architects - San Francisco 1998

Danish High Density Low Rise Housing: Housing for the Welfare State
Bratislava, Czechoslovakia 1988

Publications

Petersen + Verwers Residence
Contemporary Residences (DAAB), 2009

Folsom Street Residential Laboratory
Lofts: Living, Working & Shopping (Kolon), 2009
The Big Book of Lofts (Harper Collins), 2007
City Interiors (Loft Publications), 2006
San Francisco Business Times, February 2005

Bach Residence
California Home & Design, February 2005
New Houses (Loft Publications), November 2006

Elevation Salon + Café
Salons and Spas - The Architecture of Beauty, 2005
San Francisco Chronicle, August 2005
Minimalisme/Minimalism, 2003
Interiors, August 2000
Salon News, August 2000
International Hairdressers Journal, May 2000
Wallpaper Magazine, March 2000
Salon Today, March 2000
San Francisco Magazine, July 1999
California Real Estate Journal, March 1999

Nordic Art & Cultural Center Competition





TODD BLAKE VERWERS

Arkitekten, August 1992

Software

Vectorworks 2020
 Autocad 2014
 Adobe CS Creative Suite (Photoshop, Illustrator, InDesign, Dreamweaver, Acrobat)
 Filemaker Pro
 Microsoft Office (Word, Excel, Powerpoint)
 Mac OS10 / Microsoft Windows
 Google SketchUp

Experience

Todd Verwers Architects, Copenhagen	2009-
DISSING+WEITLING architecture a/s, Copenhagen	2007-2009
Petersen+Verwers Architecture, San Francisco	1996-2006
Studios Architecture, San Francisco	1994-1996
Tanner Leddy Maytum Stacy, San Francisco	1992-1994
DISSING+WEITLING architecture a/s, Copenhagen	1987-1992
Bent Saks Tegnestue, Copenhagen	1985-1987
Henning Larsens Tegnestue, Copenhagen	1985
Hougaard Nielsen Nørgaard Petersen, Copenhagen	1984-1985
Maynard & Partch, Anchorage	1981-1983
Novak Associates, Kansas City	1977-1980 student internship

Contact

Todd Verwers
 Todd Verwers Architects
 Hvidegaardsparken 68
 DK-2800 Kongens Lyngby
 Denmark
 +45 60134060
 todd@toddverwers.com
 Skype: tverwers



C U R R I C U L U M V I T A E



TODD BLAKE VERWERS

Project Synopsis

Todd Verwers Architects, Copenhagen

2019	Deltek Offices Copenhagen, Denmark	<i>950sm office tenant improvements</i>
2019	Skabelon Design Offices Copenhagen, Denmark	<i>750sm office tenant improvements</i>
2019	Berlingsbakke 22 Pool & Terrace Copenhagen, Denmark	<i>200sm outdoor swimming pool and terrace</i>
2017	Awapatent Offices Copenhagen, Denmark	<i>550sm office tenant improvements</i>
2016	Berlingsbakke 22 Renovations Copenhagen, Denmark	<i>650sm private home renovatiuon</i>
2013	Novo-Nordisk Building 1T Bagsværd, Denmark	<i>1,500sm addition to laboratory facility</i>
2013	DTU Relocation of Lindholm Facility Copenhagen, Denmark	<i>1,040sm biohazard laboratory/research facility</i>
2013	Montenegro Mountain Hotel Budva, Montenegro	<i>conceptual design for luxury 5 star hotel & casino</i>
2012	Cobis 2 Copenhagen, Denmark	<i>6,000sm biotech research facility</i>
2012	DTU Risø B116 Cafeteria Roskilde, Denmark	<i>1,200sm remodel of commercial kitchen</i>
2012	Frederiksborg Castle Museum Renovations Hillerød, Denmark	<i>900sm exhibition and lighting design</i>
2010	Carcassonne Hills Development Carcassonne, France	<i>housing design for golf resort development</i>
2010	Jepsen Residence Addition	<i>remodel and addition to private villa</i>



C U R R I C U L U M V I T A E



TODD BLAKE VERWERS

Kongens Lyngby, Denmark

2010	Ebay Tenant Improvements Copenhagen, Denmark	<i>450sm office tenant improvements</i>
2009	Hvidegardsparken 84 Renovations Kongens Lyngby, Denmark	<i>comprehensive remodel of private villa</i>
2009	Ebay Tenant Improvements Aarhus, Denmark	<i>office tenant improvements - 260 workstations</i>
Dissing+Weitling architecture a/s, Copenhagen		
2009	Odense Canal Link Competition Odense, Denmark Project Designer	<i>40m roadway bridge and 1400sm administration</i>
2008	Al Sowwah Bridge Vernacular Competiton Abu Dhabi, UAE Project Designer	<i>design of 13 bridges and related infrastructure</i>
2008	Adnec Pedestrian Link Bridge Abu Dhabi, UAE Project Designer	<i>250m enclosed pedestrian bridge and terminal</i>
2007	Copenhagen Towers Crowne Plaza Hotel Copenhagen, Denmark Project Architect	<i>25 story, 4 star hotel hotel and conference center</i>
Petersen+Verwers Architecture, San Francisco		
2006	Petersen/Verwers Residence San Francisco, California	<i>2500sf residential renovation</i>
2006	Claresco Tenant Improvements Berkeley, California	<i>1400sf office tenant improvements</i>

C U R R I C U L U M V I T A E



TODD BLAKE VERWERS

2006	Swedish American Hall Elevator Retrofit San Francisco, California	<i>historic building and nightclub remodel</i>
2005	Power Residence Addition Woodside, California	<i>1500sf residential addition / interior remodel</i>
2005	Stevenson/Hughes Residence Addition San Francisco, California	<i>500sf residential addition and interior renovation</i>
2005	Drury / Sung Residence Addition 2 San Francisco, California	<i>800sf residential addition and interior renovation</i>
2004	Alisa Hotel Renovations San Francisco, California	<i>hotel lobby and guestroom renovations</i>
2004	Olympic Hotel Renovations San Francisco, California	<i>hotel guestroom renovations</i>
2004	Imus / Hanlon Residence Addition Berkeley, California	<i>200sf residential addition</i>
2003	Steinberg Tenant Improvements San Francisco, California	<i>5,500sf residential loft conversion</i>
2003	Bach Residence The Sea Ranch, California	<i>1,500sf contemporary home</i>
2002	Møns Klint Visitors Center Competition Island of Møn, Denmark	<i>new 2,000sm visitors center</i>
2002	Topaz Way Development Study San Francisco, California	<i>18,000sf residential development study</i>
2001	Bozesan/Schulz Residence Los Altos Hills, California	<i>3500sf residential addition and interior renovation</i>
2001	Myers Residence Addition San Francisco, California	<i>350sf addition and kitchen remodel</i>



C U R R I C U L U M V I T A E



TODD BLAKE VERWERS

2000	Drury / Sung Residence Addition San Francisco, California	<i>300sf addition and kitchen remodel</i>
2000	723 Edgewood Road Master Plan San Mateo, California	<i>master plan concepts for residence from 1952</i>
1999	Evocative Offices Corte Madera, California	<i>3000sf office tenant improvements</i>
1999	McCann Erickson / A&L Offices San Francisco, California	<i>40,000sf tenant improvement renovation</i>
1998	Elevation Salon + Café San Francisco, California	<i>3,400 SF commercial tenant interior renovation</i>
1998	Rossi & Rovetti Flower Shop San Francisco, California	<i>600 SF retail interior renovation</i>
1998	Pasqua Coffee Shop San Francisco, California	<i>new 1200sf retail building</i>
1997	Mullens Residence Addition Burlingame, California	<i>600sf residential addition and interior renovation</i>
1996	Toan Residence Addition Marshall, California	<i>270sf two-story residential addition</i>
1996	Samaras Residence Belmont, California	<i>1,000sf residential interior renovation</i>
1996	Rasmussen Residence San Francisco	<i>120sf guest unit interior renovation</i>
	Studios Architecture, San Francisco	
1996	Johnson Residence Woodside, California	<i>new 8,000sf single family residence</i>



C U R R I C U L U M V I T A E



TODD BLAKE VERWERS

Project Designer

- | | | |
|------|---|--|
| 1996 | 425 Market Street Lobby Renovation
San Francisco
Project Architect | <i>renovation schemes for downtown lobby</i> |
| 1996 | Robertson Residence
Sonoma, California
Project Designer | <i>new 850sf single family residence</i> |
| 1995 | Bank of America Tower Signage
San Francisco
Project Designer | <i>renovation of Union 76 tower and signage</i> |
| 1995 | Phoenix Newspapers Study
Phoenix
Project Designer | <i>adaptive re-use of existing 300,000sf building</i> |
| 1994 | 3Com Building 500
Santa Clara, California
Project Designer | <i>new 240,000 SF research and production facility</i> |
| 1993 | Silicon Graphics Company Store
Mountain View, California
Project Designer | <i>new corporate in-house retail shop</i> |
| | Tanner Leddy Maytum Stacy Architects, San Francisco | |
| 1993 | Terman Engineering Annex
Palo Alto/Stanford University
Job Captain | <i>15,000sf robotics research facility</i> |
| 1993 | El Cortez Hotel and Annex
San Diego
Project Architect | <i>condominium conversion of historic 1926 hotel</i> |



C U R R I C U L U M V I T A E



TODD BLAKE VERWERS

Dissing+Weitling architecture a/s, Copenhagen

- | | | |
|------|---|---|
| 1993 | Kunstsammlung Nordrhein - Westfalen
Düsseldorf
Project Designer | <i>35,000sf addition to modern art museum</i> |
| 1992 | Novo-Nordisk Pharma Headquarters
Mainz
Project Designer | <i>new 70,000sf pharmaceutical office building</i> |
| 1992 | Hilden Business Park Competition
Düsseldorf
Project Designer | <i>180,000sf office and production complex</i> |
| 1992 | Zittadellenweg Business Park Competition
Berlin
Project Designer | <i>2,000,000sf office and production complex</i> |
| 1991 | Hamburg Electrical Works Control Room
Hamburg
Project Architect | <i>2,000sf renovation of control room</i> |
| 1991 | Novo-Nordisk A/S Board Room
Copenhagen
Project Architect | <i>3,000sf reception and board room renovation</i> |
| 1991 | Hoechst Chemical Waste Treatment Plant
Frankfurt
Project Designer | <i>Design concepts for plant aesthetics</i> |
| 1990 | Kahlke Residence Terrace Facade
Copenhagen
Project Architect | <i>Condominium facade replacement and remodel</i> |
| 1990 | Carnegie-Jensen Offices
Copenhagen
Project Designer | <i>25,000sf commercial tenant interior renovation</i> |
| 1990 | Scan-Gobain Glass A/S Offices | <i>5,000sf commercial tenant improvements</i> |



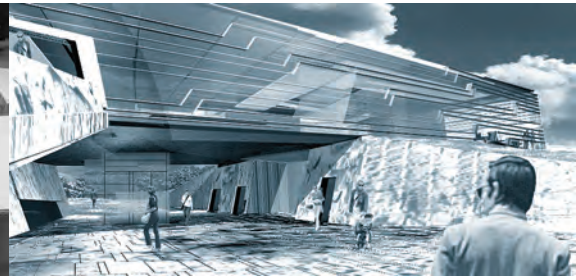
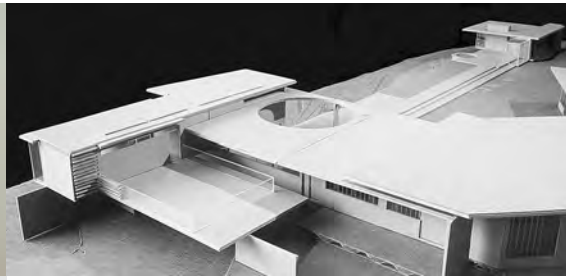
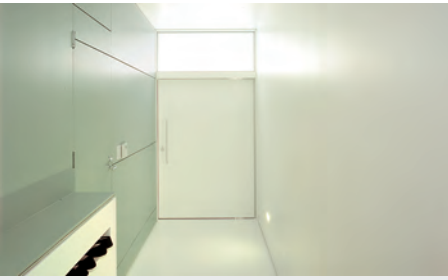

TODD BLAKE VERWERS

Copenhagen
Project Architect

- | | | |
|------|---|---|
| 1990 | World Bank Headquarters Competition
Washington D.C.
Project Designer | <i>new 2,000,000sf administrative office complex
Second Prize</i> |
| 1989 | Great Belt Bridge
The Great Belt, Denmark
Project Designer/Detailer/Illustrator | <i>6km suspension bridge component design</i> |
| 1989 | Banco de Portugal Competition
Lisbon
Project Designer/Illustrator | <i>1,035,000sf national bank facility</i> |
| 1989 | Rødovre Cultural Center
Copenhagen
Project Designer | <i>new 5,500sf theater and cinema facility</i> |
| 1988 | Copenhagen Central Station
Copenhagen
Project Designer | <i>40,000sf renovation concept for historic station</i> |
| 1987 | Copenhagen Central Station Gift Shop
Copenhagen
Project Architect | <i>1,000sf retail space in historic station hall</i> |
| 1987 | British Airways Offices
Copenhagen
Project Architect | <i>4,000sf commercial tenant interior renovation</i> |
| 1987 | IBM Hamburg Visitor Entrance
Hamburg
Project Designer | <i>new entrance to existing headquarters building</i> |

Bent Saks Tegnesteue a/s, Copenhagen



C U R R I C U L U M V I T A E



TODD BLAKE VERWERS

1986 Colas Headquarters Building *new 2,000sf commercial office building*
Copenhagen
Project Designer

1985 IKEA Shopping Center *new 57,000sf retail shopping facility*
Copenhagen
Project Designer

Henning Larsens Tegnestue a/s, Copenhagen

1985 Islamic University Competition *new 9,000,000sf university and housing complex*
Mecca *Second Prize*
Staff Designer

Hougaard Nielsen Nørgaard Petersen, Copenhagen

1986 Lautrupparken Office Building *new 100,000sf commercial office building*
Copenhagen
Staff Designer/Draftsman

Todd Verwers Arkitekt MAA, Copenhagen

1986 Nordic Art & Cultural Center Competition *new 30,000sf multi-purpose center*
Nuuk *Honorable Citation Award*
Project Architect

1992 Nordform 90 Rowhouse Competition *1,800sf prototype residential unit*
Malmö
Project Architect

1989 Ålborghallen Addition Competition *40,000sf addition to conference center*
Ålborg
Project Architect

1988 Icelandic Concert Hall Competition *new 55,000sf concert hall facility*
Reykjavik



C U R R I C U L U M V I T A E

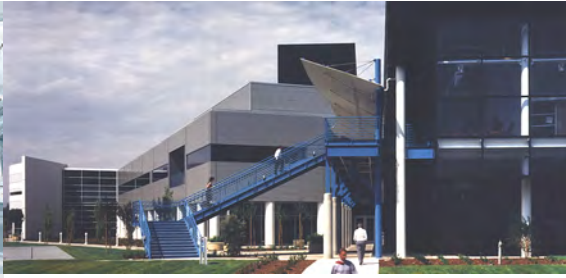

TODD BLAKE VERWERS

Project Architect

- | | | |
|------|---|---|
| 1983 | Mero Modular Carpet Tile Competition
Copenhagen
Project Designer | <i>proposals for carpet tile patterns
First Prize</i> |
| | Maynard & Partch, Anchorage | |
| 1982 | Anchorage Historical & Fine Arts Museum
Anchorage
Staff Architect | <i>80,000 SF museum addition</i> |
| 1982 | US Coast Guard Personnel Center
Kodiak, Alaska
Job Captain | <i>new 72,000 service and retail facility</i> |
| 1981 | Atka School
Atka, Alaska
Job Captain | <i>new 8,000 SF elementary school building</i> |
| 1981 | Providence House
Anchorage
Staff Architect | <i>new 4,000 SF health care facility</i> |

